



Membrane Modules

ST+RO4 Element Specifications

High Pressure, High Rejection Spacer Tube Module

Product Summary

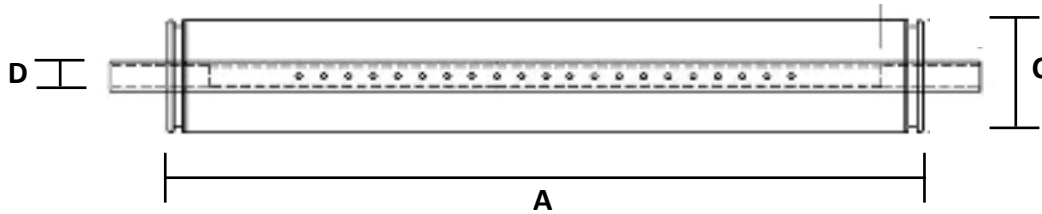

Model	RO4-8042MF-7I3F-2
Membrane Material	RO4
Construction¹	Spiral Wound Element with GRP Outerwrap and Brine Seal
Applications	High dissolved solids rejection, high pressure
Element length with ATD ("A")	1016 mm (40 in.)
Element Diameter ("C")	200 mm (7.8 in.)
Permeate Tube Outer Diameter ("D")	60.325 mm (2.375 in.)
Permeate Flowrate	18 m ³ /d (4,755 gpd)
Nominal Rejection²	99.5%
Minimum Rejection	99%
Membrane Area	26.5 m ² (285 ft ²)
Feed Spacer Thickness	Proprietary Design
Element Dry Weight	15 kg. (33 lbs.)
Max. Element ΔP	0.7 bar (10.2 psi)
Max. Overall Pressure	90 bar (943 psi)
Max. Overall Temperature	45°C (113°F)
pH Continuous	3 - 11
pH CIP³	2 - 12

¹Brine seal to be installed in flow direction on the low pressure side/element outlet side.

²Performance specifications shown are nominal values. Individual module permeate flowrates may vary by $\pm 15\%$ from the values shown. Test conditions: 32,000 mg/L NaCl Solution at 55 bar (800 psi) applied pressure, 8% recovery, 20°C (77°F) and pH 8.

³Contact Nanostone Water for more information if pH CIP requirements fall outside of these limits.